

TAS/WAHS WATER BOTTLE FILLING STATION LOCATIONS

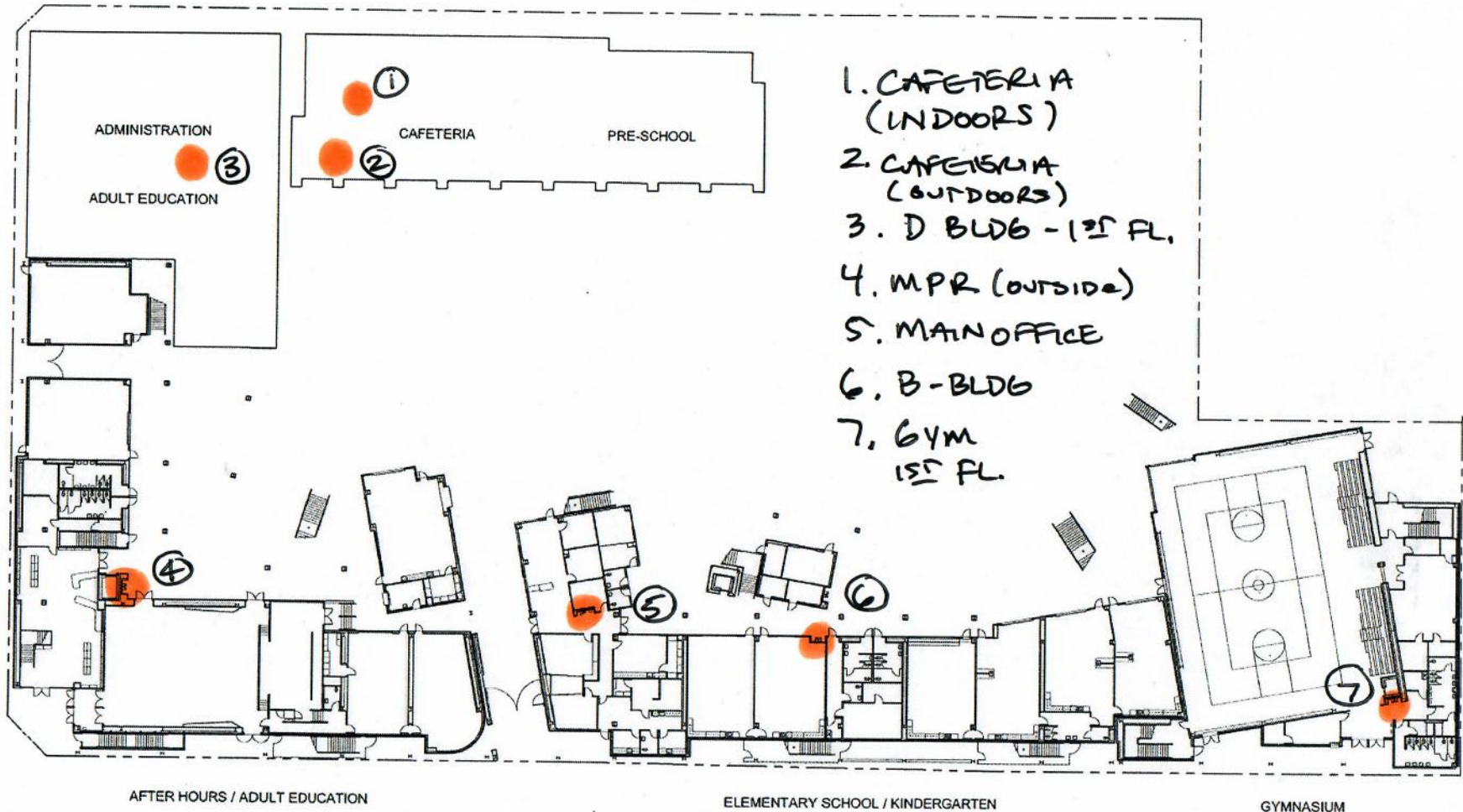

FIRST FLOOR PLAN

Scale: 1"=40'

THE ACCELERATED SCHOOL

116 EAST MARTIN LUTHER KING JR. BOULEVARD
LOS ANGELES, CALIFORNIA 90011

MARMOL RADZINER + Associates
architecture + construction AIA

2902 Nebraska Ave.
Santa Monica, California 90404
(310) 264-1814 (310) 264-1817 Fax

